

UCLF / UCF 200

FOUR-BOLT FLANGE UNITS

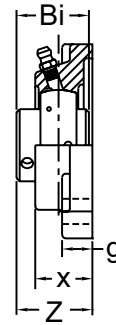

NORMAL DUTY

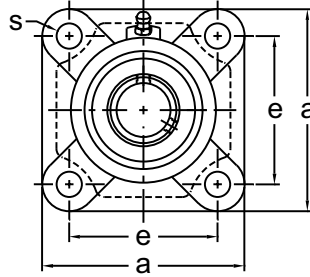

**Set-Screw Locking
Wide Inner Ring
Cast Iron Housing
Insert Detail-pg.112-113
Covers Available-pg.59
Inch and Metric**

Shaft Diam. (in.)	AMI Unit #	List Price	Dimensions (in.)							Bolt Size (in.)	Bearing #	Housing #	Weight (lb.)	
			a	e	g	x	s	Z	Bi					
1/2	UCLF201-8	44.50	3	2-1/8	3/8	1-3/32	13/32	1.287	1.024	3/8	UCW201-8	LF3	1.15	
9/16	UCLF202-9										UCW202-9		1.12	
5/8	UCLF202-10										UCW202-10		1.12	
11/16	UCLF203-11	44.50	3	2-1/8	3/8	1-3/32	13/32	1.287	1.024	3/8	UCW203-11	LF3	1.10	
1/2	UCF201-8	44.50	3-3/8	2-1/2	15/32	1	7/16	1.311	1.220	3/8	UC201-8	F204	1.41	
5/8	UCF202-10										UC202-10		1.37	
11/16	UCF203-11										UC203-11		1.34	
3/4	UCF204-12										UC204-12		1.30	
7/8	UCF205-14	49.00	3-3/4	2-3/4	9/16	1-1/16	15/32	1.406	1.339	7/16	UC205-14	F205	1.81	
15/16	UCF205-15	49.00									UC205-15			
1	UCF205-16	46.65									UC205-16			
1-1/16	UCF206-17	64.95	4-1/4	3-1/4	9/16	1-7/32	15/32	1.583	1.500	7/16	UC206-17	F206	2.42	
1-1/8	UCF206-18										UC206-18			
1-3/16	UCF206-19										UC206-19			
1-1/4	UCF206-20										UC206-20			
1-1/4	UCF207-20	75.45	4-5/8	3-5/8	5/8	1-11/32	17/32	1.748	1.689	1/2	UC207-20	F207	3.31	
1-5/16	UCF207-21										UC207-21			
1-3/8	UCF207-22										UC207-22			
1-7/16	UCF207-23										UC207-23			
1-1/2	UCF208-24	89.40	5-1/8	4	5/8	1-13/32	17/32	2.016	1.937	1/2	UC208-24	F208	4.41	
1-9/16	UCF208-25										UC208-25			
1-5/8	UCF209-26	99.60	5-3/8	4-1/8	23/32	1-1/2	19/32	2.055	1.937	9/16	UC209-26	F209	5.29	
1-11/16	UCF209-27										UC209-27			
1-3/4	UCF209-28										UC209-28			
1-7/8	UCF210-30	118.35	5-5/8	4-3/8	23/32	1-9/16	19/32	2.150	2.031	9/16	UC210-30	F210	5.51	
1-15/16	UCF210-31										UC210-31			
2	UCF210-32										UC210-32			
2	UCF211-32	146.85	6-3/8	5-1/8	25/32	1-11/16	21/32	2.299	2.189	5/8	UC211-32	F211	7.49	
2-1/8	UCF211-34										UC211-34			
2-3/16	UCF211-35										UC211-35			
2-1/4	UCF212-36	189.85	6-7/8	5-5/8	25/32	1-7/8	21/32	2.705	2.563	5/8	UC212-36	F212	10.14	
2-3/8	UCF212-38										UC212-38			
2-7/16	UCF212-39										UC212-39			
2-1/2	UCF213-40	244.60	7-3/8	5-7/8	25/32	1-31/32	21/32	2.744	2.563	5/8	UC213-40	F213	12.12	
2-11/16	UCF214-43	294.40	7-3/8	5-7/8	13/16	2-5/16	21/32	3.087	2.937	5/8	UC214-43	FX13	13.44	
2-3/4	UCF214-44										UC214-44			
2-15/16	UCF215-47	399.10	7-3/4	6	15/16	2-3/8	25/32	3.209	3.063	3/4	UC215-47	FX14	15.21	
3	UCF215-48										UC215-48			
3-1/4	UCF217-52	595.50	8-11/16	6-7/8	1-1/32	2-15/32	29/32	3.449	3.374	7/8	UC217-52	F217	20.50	
3-7/16	UCF217-55										UC217-55			
3-1/2	UCF218-56	717.10	9-1/4	7-3/8	1-1/32	2-11/16	29/32	3.791	3.780	7/8	UC218-56	F218	24.91	

Dimensions (mm)													
12	UCLF201	44.50	76	54	9.5	28	10.5	32.7	26	M8	UCW201	LF3	1.15
15	UCLF202										UCW202		1.12
17	UCLF203										UCW203		1.10
12	UCF201	44.50	86	64	12	25.4	11	33.3	31	M10	UC201	F204	1.43
15	UCF202										UC202		1.38
17	UCF203										UC203		1.36
20	UCF204	44.50	86	64	12	25.4	11	33.3	31	M10	UC204	F204	1.32
25	UCF205	49.00	95	70	14	27	12	35.7	34	M10	UC205	F205	1.83
30	UCF206	64.95	108	83	14	31	12	40.2	38.1	M10	UC206	F206	2.45
35	UCF207	75.45	117	92	16	34	13.5	44.4	42.9	M12	UC207	F207	3.35
40	UCF208	89.40	130	102	16	36	13.5	51.2	49.2	M12	UC208	F208	4.46
45	UCF209	99.60	137	105	18	38	15	52.2	49.2	M14	UC209	F209	5.35
50	UCF210	118.35	143	111	18	40	15	54.6	51.6	M14	UC210	F210	5.58
55	UCF211	146.85	162	130	20	43	17	58.4	55.6	M16	UC211	F211	7.58
60	UCF212	189.85	175	143	20	48	17	68.7	65.1	M16	UC212	F212	10.3
65	UCF213	244.60	187	149	20	50	17	69.7	65.1	M16	UC213	F213	12.3
70	UCF214	294.40	193	152	24	54	19	75.4	74.6	M16	UC214	F214	13.6
75	UCF215	399.10	200	159	24	56	19	78.5	77.8	M16	UC215	F215	15.4
80	UCF216	552.10	208	165	24	58	23	83.3	82.6	M20	UC216	F216	17.4
85	UCF217	595.50	220	175	26	63	23	87.6	85.7	M20	UC217	F217	20.8
90	UCF218	717.10	235	187	26	68	23	96.3	96	M20	UC218	F218	25.2

Lubrication fitting tap size for 1" and smaller shaft sizes, 1/4-28 UNF; for all other sizes, 1/8-27 NPT

INTERCHANGES: VF4S F4B-SC YCJ F3U-N FC4-25 FY-TF UCF SF