

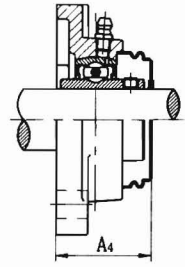

# SQUARE FLANGE UNITS

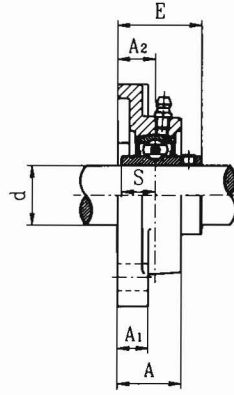
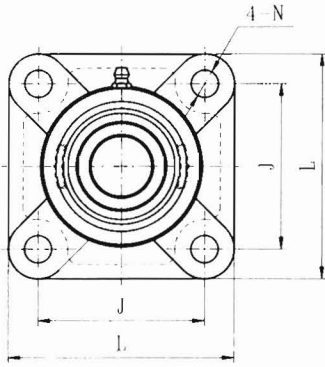

UCF2  
Setscrew type

S-UCF200E1  
SM-UCF200E1

Unit No.	Shaft Dia.		Dimensions (mm)								Bolt Size	Bearing No.	Housing No.	Mass (kg)	Available N	
	d (in.)	d (mm)	L	J	A <sub>2</sub>	A <sub>1</sub>	A	E	N	S						A <sub>4</sub>
UCF201S 201-8S 202 202-10S 203S 203-11S	1/2 5/8 11/16	12 15 17	76	54	15	11	24.5	30.9	11.5	11.5	--	M10	UC201S 201-8S 202S 202-10S 203S 203-11S	F203	0.52	--
UCF201 201-8 202 202-10 203 203-11 204-12 204	1/2 5/8 11/16 3/4	12 15 17 20	86	64	15	11	25.5	33.3	11.5	12.7	37.5	M10	UC201 201-8 202 202-10 203 203-11 204-12 204	F204	0.64	12
UCF205-14 205-15 205 205-16	7/8 15/16 1	25	95	70	16	13	27	35.7	11.5	14.3	40	M10	UC205-14 205-15 205 205-16	F205	0.80	12
UCF206-18 206 206-19 206-20	1-1/8 1-3/16 1-1/4	30	108	83	18	13	31	40.2	11.5	15.9	44	M10	UC206-18 206 206-19 206-20	F206	1.07	12
UCF207-20 207-21 207-22 207 207-23	1-1/4 1-5/16 1-3/8 1-7/16	35	117	92	19	15	34	44.4	14	17.5	48.5	M12	UC207-20 207-21 207-22 207 207-23	F207	1.40	--
UCF208-24 208-25 208	1-1/2 1-9/16	40	130	102	21	15	36	51.2	14	19	55	M12	UC208-24 208-25 208	F208	1.80	16
UCF209-26 209-27 209-28 209	1-5/8 1-11/16 1-3/4	45	137	105	22	16	38	52.2	16	19	57	M14	UC209-26 209-27 209-28 209	F209	2.20	--
UCF210-30 210-31 210	1-7/8 1-15/16	50	143	111	22	16	40	54.6	18	19	60	M16	UC210-30 210-31 210	F210	2.40	16
UCF211-32 211-34 211 211-35	2 2-1/8 2-3/16	55	162	130	25	18	43	58.4	18	22.2	64	M16	UC211-32 211-34 211 211-35	F211	3.50	19
UCF212-36 212 212-38 212-39	2-1/4 2-3/8 2-7/16	60	175	143	29	18	48	68.7	18	25.4	74.5	M16	UC212-36 212 212-38 212-39	F212	4.20	19
UCF213-40 213	2-1/2	65	187	149	30	22	50	69.7	18	25.4	79	M16	UC213-40 213	F213	5.30	19
UCF214-44 214	2-3/4	70	193	152	31	22	54	75.4	18	30.2	--	M16	UC214-44 214	F214	5.90	19
UCF215-47 215 215-48	2-15/16 3	75	200	159	34	22	56	78.5	18	33.3	--	M16	UC215-47 215 215-48	F215	6.30	19
UCF216		80	208	165	34	22	57	83.3	22	33.3	--	M20	UC216	F216	7.30	23
UCF217-52 217	3-1/4	85	220	175	36	24	63	87.6	23	34.1	--	M20	UC217-52 217	F217	8.90	
UCF218-56 218	3-1/2	90	235	187	40	25	68	96.3	23	39.7	--	M20	UC218-56 218	F218	11.6	
UCF220 220-64	4	100	265	210	44	25	70	110	27	42	--	M22	UC220 220-64	F220		