

UCFCS 200

PILOTED FLANGE CARTRIDGE UNITS



NORMAL DUTY



SealMaster® Style

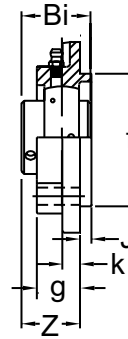
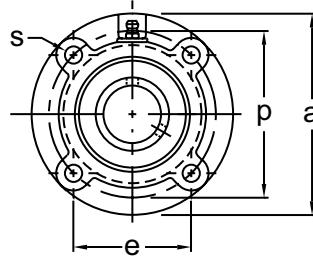

**Set-Screw Locking
Wide Inner Ring
Cast Iron Housing
Insert Detail-pg.112-113
Inch and Metric**

Shaft Diam. (in.)	AMI Unit #	List Price	Dimensions (in.)										Bolt Size (in.)	Bearing #	Housing #	Weight (lb.)
			a	p	e	s	J	k	g	f	Z	Bi				
1-1/16	UCFCS206-17	92.60	4-3/8	3-5/8	2.559	3/8	1/4	23/64	15/16	3.000	1.268	1.500	5/16	UC206-17	FCSX05	2.28
1-1/8	UCFCS206-18													UC206-18		
1-3/16	UCFCS206-19													UC206-19		
1-1/4	UCFCS206-20													UC206-20		
1-1/4	UCFCS207-20	109.50	5	4-1/8	2.921	15/32	3/8	25/64	7/8	3.375	1.315	1.689	3/8	UC207-20	FCSX06	3.14
1-5/16	UCFCS207-21													UC207-21		
1-3/8	UCFCS207-22													UC207-22		
1-7/16	UCFCS207-23													UC207-23		
1-1/2	UCFCS208-24	131.25	5-1/4	4-3/8	3.091	15/32	7/16	7/16	1-1/32	3.625	1.543	1.937	7/16	UC208-24	FCSX07	3.71
1-9/16	UCFCS208-25													UC208-25		
1-5/8	UCFCS209-26	145.70	6-1/8	5-1/8	3.625	17/32	15/32	29/64	7/8	4.250	1.408	1.937	1/2	UC209-26	FCF209	3.82
1-11/16	UCFCS209-27													UC209-27		
1-3/4	UCFCS209-28													UC209-28		
1-7/8	UCFCS210-30	171.50	6-1/8	5-1/8	3.618	35/64	15/32	7/16	1	4.250	1.598	2.031	1/2	UC210-30	FCSX09	5.20
1-15/16	UCFCS210-31													UC210-31		
2	UCFCS210-32													UC210-32		
2	UCFCS211-32	221.60	6-3/8	5-3/8	3.800	35/64	5/8	7/16	1	4.500	1.591	2.189	1/2	UC211-32	FCSX10	5.99
2-1/8	UCFCS211-34													UC211-34		
2-3/16	UCFCS211-35													UC211-35		
2-1/4	UCFCS212-36	297.65	7-1/8	6	4.232	5/8	7/8	1/2	1-1/32	5.000	1.720	2.563	1/2	UC212-36	FCSX11	8.23
2-3/8	UCFCS212-38													UC212-38		
2-7/16	UCFCS212-39													UC212-39		
2-1/2	UCFCS213-40	384.20	7-5/8	6-1/2	4.594	5/8	25/32	9/16	1-5/16	5.500	1.996	2.563	1/2	UC213-40	FCSX12	9.57
2-11/16	UCFCS214-43	417.55	7-5/8	6-1/2	4.594	5/8	25/32	9/16	1-5/16	5.500	2.181	2.937	1/2	UC214-43	FCSX13	11.36
2-3/4	UCFCS214-44													UC214-44		
2-15/16	UCFCS215-47	578.50	8-3/4	7-1/2	5.303	3/4	25/32	9/16	1-13/32	6.375	2.303	3.063	5/8	UC215-47	FCSX14	12.40
3	UCFCS215-48													UC215-48		
Dimensions (mm)																
30	UCFCS206	92.60	111	92	65	9.5	6.4	9	24	76.2	32.2	38.1	M8	UC206	FCSX05	2.28
35	UCFCS207	109.50	127	105	74.2	12	9.5	10	22	85.7	33.4	42.9	M10	UC207	FCSX06	3.14
40	UCFCS208	131.25	133	111	78.5	12	11	11	26	92.1	39.2	49.2	M10	UC208	FCSX07	3.71
45	UCFCS209	145.70	155	130	92.1	13.5	12	12	22	108.0	35.8	49.2		UC209	FCF209	3.82
50	UCFCS210	171.50	155	130	91.9	14	12	11	25	108.0	40.6	51.6	M12	UC210	FCSX09	5.20
55	UCFCS211	221.60	162	136.5	96.5	14	15.9	11	25	114.3	40.4	55.6		UC211	FCSX10	5.99
60	UCFCS212	297.65	181	152	107.5	16	22.2	13	26	127.0	43.7	65.1		UC212	FCSX11	8.23
65	UCFCS213	384.25	194	165	116.7	16	19.8	14	33	139.7	50.7	65.1	M14	UC213	FCSX12	9.57
70	UCFCS214	417.55	194	165	116.7	16	19.8	14	33	139.7	55.4	74.6		UC214	FCSX13	11.36
75	UCFCS215	578.50	222	190.5	134.7	19	19.8	14	36	161.9	58.5	77.8	M16	UC215	FCSX14	11.38

Lubrication fitting tap size for 1" and smaller shaft sizes, 1/4-28 UNF; for all other sizes, 1/8-27 NPT

INTERCHANGES: VFCS FC-SC PFC4-25 SFC