

# UCFCSX / UCFC X00 PILOTED FLANGE CARTRIDGE UNITS

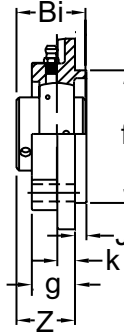

SealMaster® Style

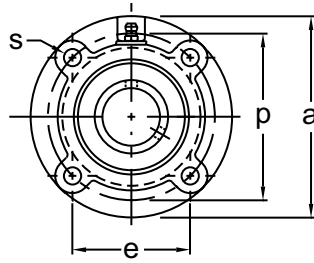

**Set-Screw Locking  
Wide Inner Ring  
Cast Iron Housing  
Insert detail-pg.122  
Inch and Metric**

MEDIUM DUTY

Shaft Diam. (in.)	AMI Unit #	List Price	Dimensions (in.)										Bolt Size (in.)	Bearing #	Housing #	Weight (lb.)
			a	p	e	s	J	k	g	f	z	Bi				
1	UCFCSX05-16	87.45	4-3/8	3-5/8	2.559	3/8	1/4	23/64	15/16	3.000	1.268	1.500	5/16	UCX05-16	FCSX05	2.42
1-1/8	UCFCSX06-18	103.65	5	4-1/8	2.921	15/32	3/8	25/64	7/8	3.375	1.315	1.689	3/8	UCX06-18	FCSX06	3.09
1-3/16	UCFCSX06-19													UCX06-19		
1-1/4	UCFCSX06-20													UCX06-20		
1-1/4	UCFCSX07-20	134.10	5-1/4	4-3/8	3.091	15/32	7/16	7/16	1-1/32	3.625	1.543	1.937	3/8	UCX07-20	FCSX07	3.97
1-3/8	UCFCSX07-22													UCX07-22		
1-7/16	UCFCSX07-23													UCX07-23		
1-1/2	UCFCSX08-24	166.25	5-1/4	4-3/8	3.091	15/32	7/16	7/16	1-1/32	3.625	1.543	1.937	3/8	UCX08-24	FCX08	3.97
1-1/2	UCFCMX08-24	166.25	6-1/8	5-1/8	3.625	17/32	15/32	29/64	7/8	4.250	1.408	1.937	1/2	UCX08-24	FCF209	3.97
1-5/8	UCFCSX09-26	180.85	6-1/8	5-1/8	3.618	35/64	15/32	7/16	1	4.250	1.598	2.031	1/2	UCX09-26	FCSX09	5.51
1-11/16	UCFCSX09-27													UCX09-27		
1-3/4	UCFCSX09-28													UCX09-28		
1-7/8	UCFCSX10-30	208.35	6-3/8	5-3/8	3.800	35/64	5/8	7/16	1	4.500	1.591	2.189	1/2	UCX10-30	FCSX10	6.39
1-15/16	UCFCSX10-31													UCX10-31		
2	UCFCSX10-32													UCX10-32		
2	UCFCSX11-32	262.85	7-1/8	6	4.232	5/8	7/8	1/2	1-1/32	5.000	1.720	2.563	1/2	UCX11-32	FCSX11	8.82
2-3/16	UCFCSX11-35													UCX11-35		
2-1/4	UCFCSX11-36													UCX11-36		
2-3/8	UCFCSX12-38	323.10	7-5/8	6-1/2	4.594	5/8	25/32	9/16	1-5/16	5.500	1.996	2.563	1/2	UCX12-38	FCSX12	10.14
2-7/16	UCFCSX12-39													UCX12-39		
2-1/2	UCFCSX13-40													UCX13-40		
2-1/2	UCFCSX13-40	380.75	7-5/8	6-1/2	4.594	5/8	25/32	9/16	1-5/16	5.500	2.181	2.937	1/2	UCX13-40	FCSX13	10.80
2-11/16	UCFCSX14-43	459.75	8-3/4	7-1/2	5.303	3/4	25/32	9/16	1-13/32	6.375	2.303	3.063	5/8	UCX14-43	FCSX14	16.31
2-3/4	UCFCSX14-44													UCX14-44		
2-15/16	UCFCSX15-47	508.20	8-3/4	7-1/2	5.303	3/4	7/8	5/8	1-3/8	6.375	2.413	3.252	5/8	UCX15-47	FCSX15	16.31
3	UCFCSX15-48													UCX15-48		
3-3/16	UCFCSX16-51	693.05	10-1/4	8-5/8	6.094	29/32	1	3/4	1-13/32	7.323	2.425	3.374	3/4	UCX16-51	FCSX16	25.35
3-1/4	UCFCSX17-52	741.85	10-1/4	8-5/8	6.094	29/32	1	3/4	1-13/32	7.375	2.610	3.780	3/4	UCX17-52	FCSX17	24.46
3-7/16	UCFCSX17-55													UCX17-55		
3-1/2	UCFCSX18-56	963.75	10-1/4	8-5/8	6.094	29/32	1-3/32	3/4	1-11/16	7.375	2.878	4.094	3/4	UCX18-56	FCSX18	24.91
3-15/16	UCFCSX20-63	1309.55	10-7/8	9-3/8	6.626	29/32	1-3/32	7/8	2-19/32	8.125	3.555	4.626	3/4	UCX20-63	FCSX20	35.04
4	UCFCSX20-64													UCX20-64		
Dimensions (mm)																
25	UCFCX05	87.45	111	92	65	9.5	6	9.5	24	76	32.2	38.1	M8	UCX05	FCX05	2.45
30	UCFCX06	103.65	127	105	74.2	12	9.5	9.5	22.5	85	33.4	42.9	M10	UCX06	FCX06	3.12
35	UCFCX07	134.10	133	111	78.5	12	11	11	26	92	39.2	49.2	M10	UCX07	FCX07	4.01
40	UCFCX08	166.25	133	111	78.5	12	11	11	26	92	39.2	49.2	M10	UCX08	FCX08	4.01
45	UCFCX09	180.85	155	130	91.9	14	12	11	25	108	40.6	51.6	M12	UCX09	FCX09	5.58
50	UCFCX10	208.35	162	136	96.2	14	16	11	25	118	40.4	55.6	M12	UCX10	FCX10	6.47
55	UCFCX11	262.85	180	152	107.5	16	22	13	26	127	43.7	65.1	M14	UCX11	FCX11	8.92
60	UCFCX12	323.10	194	165	116.7	16	20	14	33	140	50.7	65.1		UCX12	FCX12	10.3
65	UCFCX13	380.75	194	165	116.7	16	20	14	33	140	55.4	74.6		UCX13	FCX13	11.0
70	UCFCX14	459.75	222	190	134.3	19	20	14	36	164	58.5	77.8	M16	UCX14	FCX14	16.5
75	UCFCX15	508.20	222	190	134.3	19	22	16	35	164	61.3	82.6	M16	UCX15	FCX15	16.5
80	UCFCX16	693.05	260	219	154.8	23	25	19	36	186	61.6	85.7	M20	UCX16	FCX16	25.7
85	UCFCX17	741.85	260	219	154.8	23	25	19	36	186	66.3	96	M20	UCX17	FCX17	24.8
90	UCFCX18	963.75	260	219	154.8	23	28	19	43	186	73.1	104		UCX18	FCX18	25.2
100	UCFCX20	1309.55	276	238	168.3	23	28	22	66	206	90.3	117.5		UCX20	FCX20	35.5

Lubrication fitting tap size 1/8-27 NPT

**INTERCHANGES: VFCS-3 FC-SCM MFC PFC4-35 UCFCX**